



# AZ-303<sup>Q&As</sup>

Microsoft Azure Architect Technologies

## Pass Microsoft AZ-303 Exam with 100% Guarantee

Free Download Real Questions & Answers **PDF** and **VCE** file from:

<https://www.lead4pass.com/az-303.html>

100% Passing Guarantee  
100% Money Back Assurance

Following Questions and Answers are all new published by Microsoft  
Official Exam Center

-  **Instant Download** After Purchase
-  **100% Money Back** Guarantee
-  **365 Days** Free Update
-  **800,000+** Satisfied Customers





### QUESTION 1

DRAG DROP

You have an Azure subscription that contains the following resources:

1.  
a virtual network named VNet1
2.  
a replication policy named RepIPoHcy1
3.  
a Recovery Services vault named Vault1
4.  
an Azure Storage account named Storage1

You have an Amazon Web Services (AWS) EC2 virtual machine named VM1 that runs Windows Server 2016.

You need to migrate VM1 to VNet1 by using Azure Site Recovery.

Which three actions should you perform in sequence? To answer, move the appropriate actions from the list of actions to the answer area and arrange them in the correct order

Select and Place:



Correct Answer:

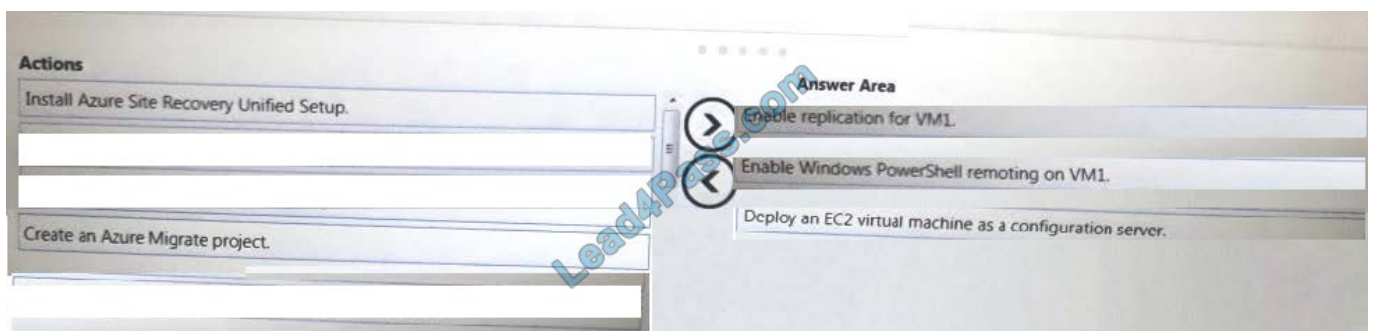



## QUESTION 2

### DRAG DROP

You have an Azure subscription that is used by four departments in your company. The subscription contains 10 resource groups. Each department uses resources in several resource groups.

You need to send a report to the finance department. The report must detail the costs for each department.

Which three actions should you perform in sequence? To answer, move the appropriate actions from the list of actions to the answer area and arrange them in the correct order.

Select and Place:

Actions	Answer Area
Open the <b>Resource costs</b> blade of each resource group.	
From the Cost analysis blade, filter the view by tag.	
Assign a tag to each resource.	
Assign a tag to each resource group.	
Download the usage report.	

Correct Answer:

Actions	Answer Area
Open the <b>Resource costs</b> blade of each resource group.	Assign a tag to each resource.
From the Cost analysis blade, filter the view by tag.	From the Cost analysis blade, filter the view by tag.
Assign a tag to each resource.	
Assign a tag to each resource group.	
Download the usage report.	Download the usage report.

Box 1: Assign a tag to each resource.

You apply tags to your Azure resources giving metadata to logically organize them into a taxonomy. After you apply tags, you can retrieve all the resources in your subscription with that tag name and value. Each resource or resource group

can have a maximum of 15 tag name/value pairs. Tags applied to the resource group are not inherited by the resources in that resource group.

Box 2: From the Cost analysis blade, filter the view by tag

After you get your services running, regularly check how much they're costing you. You can see the current spend and



burn rate in Azure portal.

1. Visit the Subscriptions blade in Azure portal and select a subscription.

1.

You should see the cost breakdown and burn rate in the popup blade.

2.

Click Cost analysis in the list to the left to see the cost breakdown by resource. Wait 24 hours after you add a service for the data to populate.

3.

You can filter by different properties like tags, resource group, and timespan. Click Apply to confirm the filters and Download if you want to export the view to a Comma-Separated Values (.csv) file.

Box 3: Download the usage report

References: <https://docs.microsoft.com/en-us/azure/azure-resource-manager/resource-group-using-tags>

<https://docs.microsoft.com/en-us/azure/billing/billing-getting-started>

---

### QUESTION 3

Note: This question is part of series of questions that present the same scenario. Each question in the series contains a unique solution that might meet the stated goals. Some question sets might have more than one correct solution, while others might not have a correct solution.

After you answer a question in this section, you will NOT be able to return to it. As a result, these questions will not appear in the review screen.

A company backs up data to on-premises servers at their main facility. The company currently has 30 TB of archived data that infrequently used. The facility has download speeds of 100 Mbps and upload speeds of 20 Mbps.

You need to securely transfer all backups to Azure Blob Storage for long-term archival. All backup data must be sent within seven days.

Solution: Create a file share in Azure Files. Mount the file share to the server and upload the files to the file share. Transfer the files to Azure Blob Storage.

Does this meet the goal?

A. Yes

B. No

Correct Answer: B

---

### QUESTION 4



### DRAG DROP

You need to identify the appropriate sizes for the Azure virtual machines.

Which five actions should you perform in sequence? To answer, move the appropriate actions from the list of actions to the answer area and arrange them in the correct order.

Select and Place:

#### Actions

From the Azure portal, create an Azure Migrate assessment.

From the Azure portal, create an Azure Migrate project.

From VM1, connect to the collector virtual machine and run the Azure Site Recovery deployment planner.

From the Azure portal, download an OVA file.

From VM1, connect to the collector virtual machine and run the Azure Migrate Collector.

From Microsoft Download Center, download the Azure Site Recovery deployment planner.

From VM1, run the Deploy OVF Template wizard.

#### Answer Area



Correct Answer:



### Actions

From VM1, connect to the collector virtual machine and run the Azure Site Recovery deployment planner.

From Microsoft Download Center, download the Azure Site Recovery deployment planner

### Answer Area

From the Azure portal, create an Azure Migrate project.

From the Azure portal, download an OVA file.

From VM1, run the Deploy OVF Template wizard.

From VM1, connect to the collector virtual machine and run the Azure Migrate Collector.

From the Azure portal, create an Azure Migrate assessment.



References: <https://docs.microsoft.com/en-us/azure/migrate/tutorial-assessment-vmware>

### QUESTION 5

#### HOTSPOT

You plan to deploy five virtual machines to a virtual network subnet. Each virtual machine will have a public IP address and a private IP address. Each virtual machine requires the same inbound and outbound security rules. What is the minimum number of network interfaces and network security groups that you require? To answer, select the appropriate



options in the answer area.

NOTE: Each correct selection is worth one point.

Hot Area:

Minimum number of network interfaces:

	v
5	
10	
15	
20	

Minimum number of network security groups:

	v
1	
2	
5	
10	

Correct Answer:

Minimum number of network interfaces:

	v
5	
10	
15	
20	

Minimum number of network security groups:

	v
1	
2	
5	
10	

By Default Inbound and Outbound Security Rules are same for all VMs. Therefore, if default rules suffice, then there is no need for NSG at all. 5 NICs and 1 NSG for non-default Inbound and Outbound Rules 5 Nics and 0 NSG for default Inbound and Outbound Rules.

### QUESTION 6



You need to ensure that the Policy service can implement the policy actions. Which code segment should you insert at line EG07 in EventGridController.cs?

- A. 

```
if (HttpContext.Request.Headers["aeg-event-type"].FirstOrDefault() == "SubscriptionValidation")
{
    return new JsonResult(new
    {
        validationResponse = events[0]["validationCode"]
    });
}
```
- B. 

```
if (events[0]["eventType"].ToString() == "SubscriptionValidation")
{
    return new JsonResult(new
    {
        validationResponse = events[0]["validationCode"]
    });
}
```
- C. 

```
if (HttpContext.Request.Headers["aeg-event-type"].FirstOrDefault() == "SubscriptionValidation")
{
    return new JsonResult(new
    {
        validationResponse = events[0]["data"]["validationCode"]
    });
}
```
- D. 

```
if (events[0]["subject"].ToString() == "SubscriptionValidation")
{
    return new JsonResult(new
    {
        validationResponse = events[0]["data"]["validationCode"]
    });
}
```

A. Option A

B. Option B

C. Option C

D. Option D

Correct Answer: C

## QUESTION 7





You are developing an ASP.NET web application that you will deploy to Azure. The solution must meet the following requirements:

- Store user session state by using only serializable data types.
- Provide customizable caching of session data.
- Support scaling out the number of web hosts
- Maximize performance.

Which solution meets these requirements?

- A.  
Clustered Azure Redis Cache
- B.  
ASP.NET Output Cache provider for Azure Redis Cache
- C.  
in-memory session state provider
- D.  
SQL Server session state provider

Correct Answer: B

---

### QUESTION 8

After you answer a question in this section, you will NOT be able to return to it. As a result, these questions will not appear in the review screen.

You have an Azure Active Directory (Azure AD) tenant named contoso.com.

A user named Admin1 attempts to create an access review from the Azure Active Directory admin center and discovers that the Access reviews settings are unavailable. Admin1 discovers that all the other Identity Governance settings are available.

Admin1 is assigned the User administrator, Compliance administrator, and Security administrator roles.



You need to ensure that Admin1 can create access reviews in contoso.com.

Solution: You assign the Service administrator role to Admin1.

Does this meet the goal?

A. Yes

B. No

Correct Answer: B

Instead use Azure AD Privileged Identity Management.

Note: PIM essentially helps you manage the who, what, when, where, and why for resources that you care about. Key features of PIM include: Conduct access reviews to ensure users still need roles

References: <https://docs.microsoft.com/en-us/azure/active-directory/privileged-identity-management/pim-configure>

#### QUESTION 9

You have an Azure subscription that contains the resources shown in the following table.

Name	Type	Address space
VNET1	Virtual network	10.1.1.0/24
Subnet1	Subnet	10.1.1.0/24
VM1	Virtual machine	<i>Not applicable</i>

Subnet1 is on VNET1. VM1 connects to Subnet1.

You plan to create a virtual network gateway on VNET1.

You need to prepare the environment for the planned virtual network gateway.

What are two ways to achieve this goal? Each correct answer presents a complete solution.

NOTE: Each correct selection is worth one point.

- A. Modify the address space used by VNET1.
- B. Modify the address space used by Subnet1.
- C. Create a subnet named GatewaySubnet on VNET1.
- D. Create a local network gateway.
- E. Delete Subnet1.

Correct Answer: AE



## QUESTION 10

### HOTSPOT

You have an Azure Resource Manager template for a virtual machine named Template1. Template1 has the following parameters section.

```
"parameters": {
  "adminUsername": {
    "type": "string"
  },
  "adminPassword": {
    "type": "securestring"
  },
  "dnsLabelPrefix": {
    "type": "string"
  },
  "windowsOSVersion": {
    "type": "string",
    "defaultValue": "2016-Datacenter",
    "allowedValues": [
      "2016-Datacenter",
      "2019-Datacenter"
    ]
  },
  "location": {
    "type": "String",
    "allowedValues": [
      "eastus",
      "centralus",
      "westus" ]
  }
},
```

For each of the following statements, select Yes if the statement is true. Otherwise, select No.

NOTE: Each correct selection is worth one point.

Hot Area:



### Answer Area

Statements	Yes	No
When you deploy Template1, you are prompted for a resource group.	<input type="radio"/>	<input type="radio"/>
When you deploy Template1, you are prompted for the Windows operating system version.	<input type="radio"/>	<input type="radio"/>
When you deploy Template1, you are prompted for a location.	<input type="radio"/>	<input type="radio"/>

Correct Answer:

### Answer Area

Statements	Yes	No
When you deploy Template1, you are prompted for a resource group.	<input checked="" type="radio"/>	<input type="radio"/>
When you deploy Template1, you are prompted for the Windows operating system version.	<input type="radio"/>	<input checked="" type="radio"/>
When you deploy Template1, you are prompted for a location.	<input checked="" type="radio"/>	<input type="radio"/>

Box 1: Yes

The Resource group is not specified.

Box 2: No

The default value for the operating system is Windows 2016 Datacenter.

Box 3: Yes

Location is no default value.

References:

<https://docs.microsoft.com/bs-latn-ba/azure/virtual-machines/windows/ps-template>

### QUESTION 11

Your company plans to develop an application that will use a NoSQL database. The database will be used to store



transactions and customer information by using JSON documents.

Which two Azure Cosmos DB APIs can developers use for the application? Each correct answer presents a complete solution.

NOTE: Each correct selection is worth one point.

- A. Cassandra
- B. Gremlin (graph)
- C. MongoDB
- D. Azure Table
- E. Core (SQL)

Correct Answer: DE

---

#### QUESTION 12

You have an Azure Active Directory (Azure AD) tenant that contains a group named Group 1. You need to enable multi-factor authentication (MFA) for me users in Group1 only.

Solution: From the Azure portal you create a conditional access policy. Does this meet the goal?

- A. Yes
- B. No

Correct Answer: A

---

#### QUESTION 13

You have an Azure subscription that contains three virtual networks named VNet1, VNet2, and VNet3. VNet2 contains a virtual appliance named VM2 that operates as a router.

You are configuring the virtual networks in a hub and spoke topology that uses VNet2 as the hub network.

You plan to configure peering between VNet1 and VNet2 and between VNet2 and VNet3.

You need to provide connectivity between VNet1 and VNet3 through VNet2.

Which two configurations should you perform? Each correct answer presents part of the solution.

NOTE: Each correct selection is worth one point.

- A. On the peering connections, allow forwarded traffic
- B. Create a route filter



- C. On the peering connections, allow gateway transit
- D. Create route tables and assign the table to subnets
- E. On the peering, use remote gateways

Correct Answer: CE

Allow gateway transit: Check this box if you have a virtual network gateway attached to this virtual network and want to allow traffic from the peered virtual network to flow through the gateway.

The peered virtual network must have the Use remote gateways checkbox checked when setting up the peering from the other virtual network to this virtual network.

References:

<https://docs.microsoft.com/en-us/azure/virtual-network/virtual-network-manage-peering#requirements-and-constraints>

[Latest AZ-303 Dumps](#)

[AZ-303 Practice Test](#)

[AZ-303 Braindumps](#)



To Read the [Whole Q&As](#), please purchase the [Complete Version](#) from [Our website](#).

## Try our product !

100% Guaranteed Success

100% Money Back Guarantee

365 Days Free Update

Instant Download After Purchase

24x7 Customer Support

Average 99.9% Success Rate

More than 800,000 Satisfied Customers Worldwide

Multi-Platform capabilities - [Windows](#), [Mac](#), [Android](#), [iPhone](#), [iPod](#), [iPad](#), [Kindle](#)

We provide exam PDF and VCE of Cisco, Microsoft, IBM, CompTIA, Oracle and other IT Certifications. You can view Vendor list of All Certification Exams offered:

<https://www.lead4pass.com/allproducts>

## Need Help

Please provide as much detail as possible so we can best assist you.

To update a previously submitted ticket:



 <p><b>One Year Free Update</b> Free update is available within One Year after your purchase. After One Year, you will get 50% discounts for updating. And we are proud to boast a 24/7 efficient Customer Support system via Email.</p>	 <p><b>Money Back Guarantee</b> To ensure that you are spending on quality products, we provide 100% money back guarantee for 30 days from the date of purchase.</p>	 <p><b>Security &amp; Privacy</b> We respect customer privacy. We use McAfee's security service to provide you with utmost security for your personal information &amp; peace of mind.</p>
---	---	--

Any charges made through this site will appear as Global Simulators Limited.

All trademarks are the property of their respective owners.

Copyright © lead4pass, All Rights Reserved.